



PLAY TO LEARN

LEARNING IN ACTION

LEARNING IN ACTION

AN INTEGRAL COMBINATION OF PLAY • ARTS • ATHLETICS



Slated to be inaugurated Spring 2022, this expansive facility will include a rooftop field, indoor gymnasium, performing arts stage, dance studio, and two music classrooms, which will provide a platform for our students to discover and showcase their talents, expand their minds, and let their imaginations wander.

Through your donation to The Cushman School's Play to Learn Campaign, families like yours can actively enable the creative and athletic development of your child(ren), traits that have been widely recognized as catalysts for heightened academic achievement, as well as enhanced physical and psychological well-being.

One of the defining features that sets The Cushman School apart from other institutions is its commitment to championing academic excellence in a stimulating environment where both creativity and athleticism are celebrated. For this reason, the School has placed significant resources on developing a holistic curriculum that expands the learning horizons of its students through facilitating enriching experiences.

Through its Play to Learn Campaign, The Cushman School aims to raise funds to complete the state-of-the-art performing arts and athletic center. A place where students have the opportunity to express themselves imaginatively, form lifelong relationships, and learn dedication, commitment, and discipline.



THE VISIONARY CLUB

Game Changers \$500k and up	Play to Learn Building	\$4,000,000
	Rooftop Futsal Soccer Field	\$1,500,000
	Play to Learn Courtyard (turf + play areas)	\$1,000,000
	Performing Arts Wing	\$1,000,000
	Gymnasium	\$1,000,000
Directors and Coaches \$250k up to \$500k	Music Room (2 available)	\$1,000,000
	Indoor Scoreboard	\$200,000
Stars and MVPs \$100k up to \$250k	Lighting & Sound Booth	\$200,000
	Hallway of Achievements	\$100,000
	Snack Shack	\$100,000
	Southeast Entry	\$100,000
	Backstage Entrance	\$50,000
Cast and Team Players \$25k up to \$100k	Elevator to Rooftop	\$50,000
	The Climb (Stairs) to Rooftop (2 available)	\$50,000

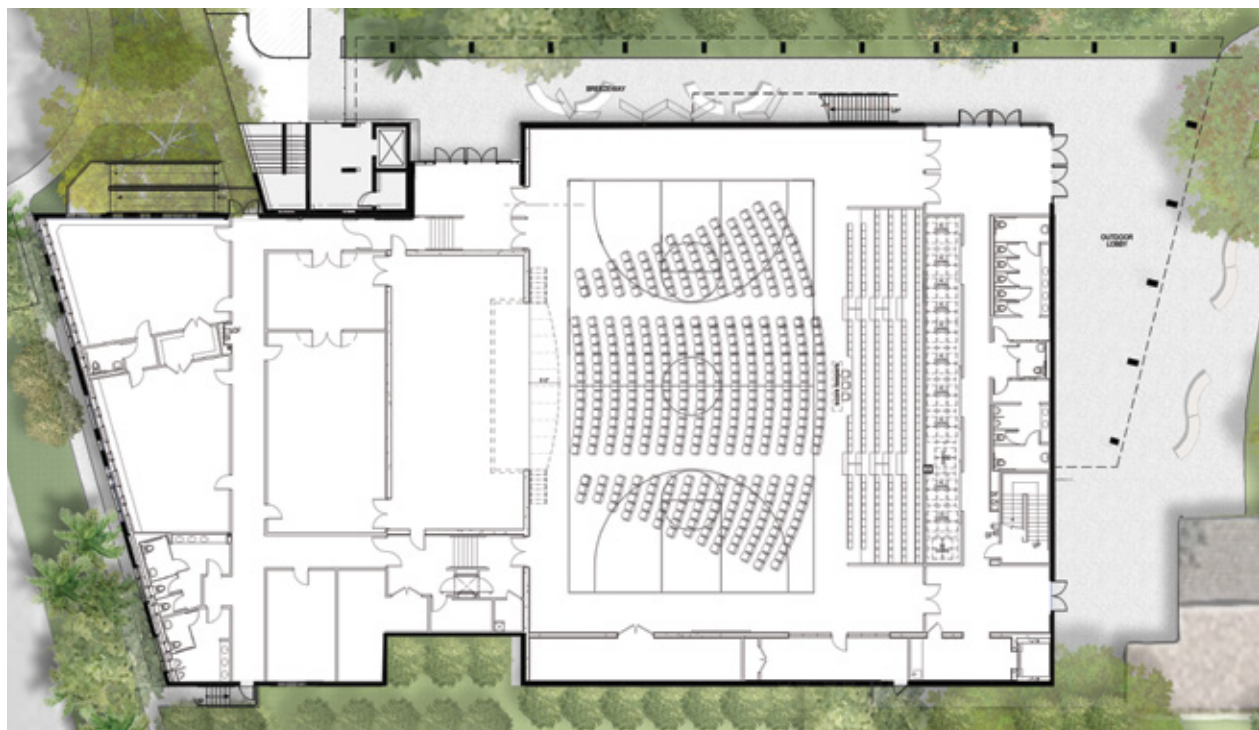





*Schematic plans subject to change

EVERY DONATION, ANY AMOUNT, COUNTS TOWARD OUR GOAL

PLEDGES. CASH. SECURITIES.

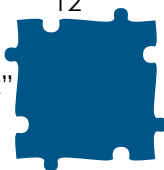
Consider purchasing an inscribed puzzle piece on our donor wall with a multi-year pledge and be a piece of our future!

PUZZLE PIECES		1 YEAR		2 YEARS	
6" 	= \$5,000 =	\$417/Month =	= <u>\$2,500/Year</u>		\$208/Month
6" 	= \$10,000 =	\$833/Month =	= <u>\$5,000/Year</u>		\$417/Month
6" 	= \$15,000 =	\$1,250/Month =	= <u>\$7,500/Year</u>		\$625/Month
12" 	= \$20,000 =	\$1,667/Month =	= <u>\$10,000/Year</u>		\$833/Month
 PLAY TO LEARN Heartfelt SUPPORTER	= \$50,000 =	\$4,167/Month =	= <u>\$25,000/Year</u>		\$2,083/Month

This heart shaped puzzle will be displayed at the heart of the building. Become one of the 14 Heartfelt Supporters and obtain your piece of our heart. Each heart shaped piece will be \$50,000.



If you are interested in a naming opportunity or additional information about Play to Learn please contact James Knapp at jknapp@cushmanschool.org | (954) 662-6212

The Cushman School

AN IDENTITY LINKED TO EXCELLENCE

Main Campus (Pre-K – 8th grade) | 592 NE 60th Street | Miami, FL 33137

High School Campus (9th – 12th grade) | 4700 Biscayne Blvd. | Miami, FL 33137

Advancement Office | 592 NE 60th Street | Miami, FL 33137 | Tel: (305) 757-1966

cushmanschool.org